

PARTS LIST			
ITEM	DESCRIPTION	QTY	P/N
1	STEEL BASE	1	STL-1005
2	STUD	5	SCR-1258
3	CASTER	5	CAS-1151
4	ESNA NUT	5	SCR-1257
5	WASHER	5	SCR-1341
6	WASHER	1	SCR-1274
7	HEX BOLT	1	SCR-1349
8	TAPERED PIN	1	STL-1032
9	BASE POLE	1	TUB-1268
10	BUSHING	1	PLS-1436
11	BASKET	1	MIS-1573
12	MOUNT	1SET	PLS-1496
13	SCREWS	2	SCR-1375
14	TUBE	1	TUB-1202
15	END CAPS	2	MIS-1461
16	SCREW	1	SCR-1567
17	SWIVEL MOUNT	1	PLS-1470
18	HEAD UNIT	1	STL-1525
19	SCREWS	3	SCR-1314
20	SECURITY CLIP	1	SST-1027
21	SCREW	1	SCR-1344
22	WASHER	1	SCR-1323
23	THERMOMETER BRACKET	1	65161-0000
24	SCREW	2	SCR-1319
25	WASHER	2	SCR-1323
26	PROBE HOLDER	1	65163-0000
27	SCREW	1	SCR-1572
28	SCREW	2	SCR-1265
29	MFG. LABEL	1	LBL-1676
NOT SHOWN	TAMPER PROOF HEX KEY	1	SCR-1320
PACKAGE	CARTON	1	PAC-1527
	INSERT	1	PAC-1528
	INSTRUCTION SHEET	1	LBL-1919

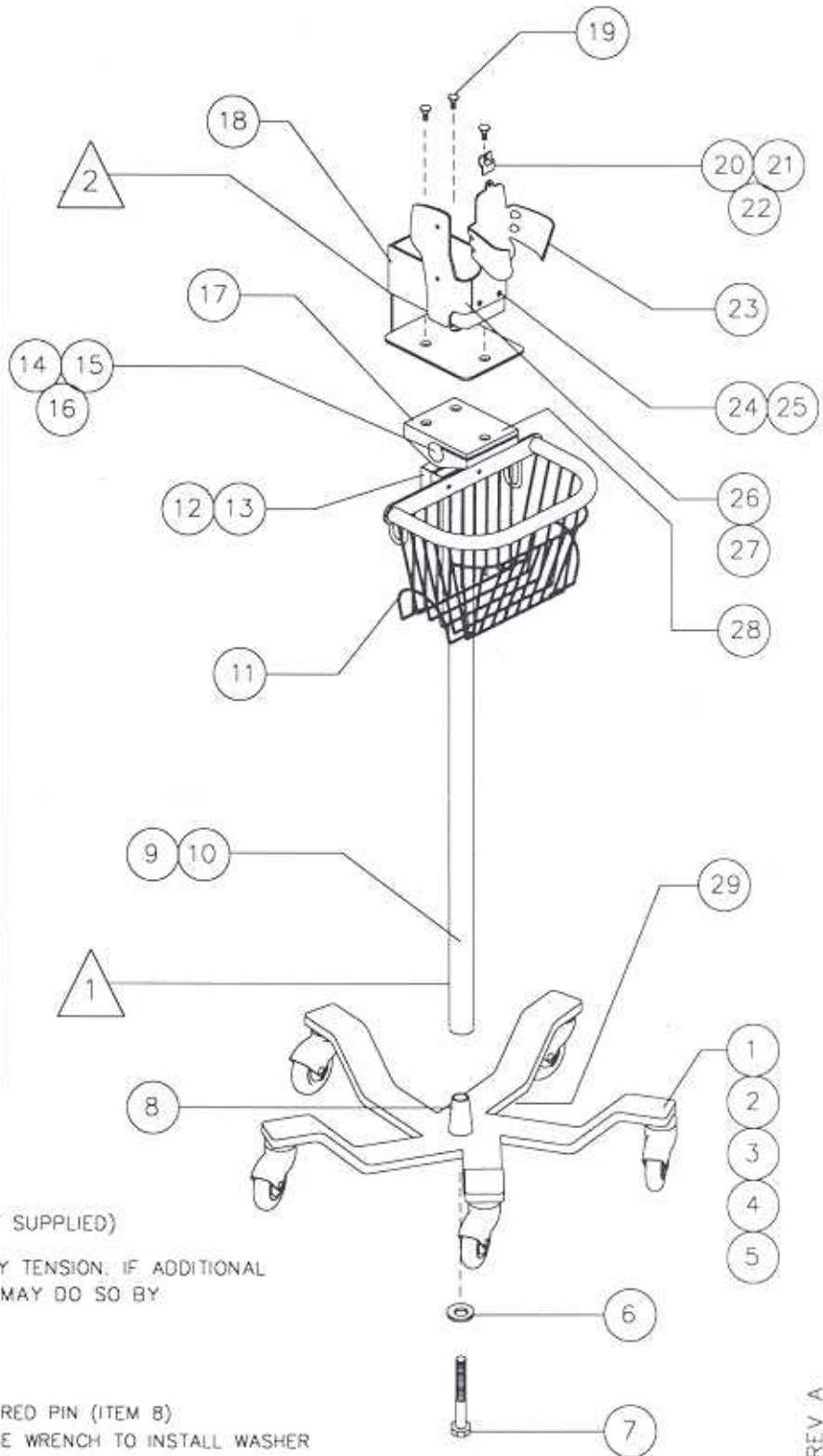

ASSEMBLY INSTRUCTIONS:

TOOLS REQUIRED: • HEX KEY (SUPPLIED)
 WRENCH (NOT SUPPLIED)
 PHILLIPS SCREWDRIVER (NOT SUPPLIED)

NOTE: ALL HEAD UNITS ARE SET TO A FACTORY TENSION. IF ADDITIONAL TIGHTENING OR LOOSENING ARE REQUIRED YOU MAY DO SO BY ADJUSTING SCREWS (ITEM 28)

1 — SLIDE POLE WITH BUSHING (ITEM 9) OVER TAPERED PIN (ITEM 8). TIP 5-LEG BASE TO EXPOSE BASE BOTTOM. USE WRENCH TO INSTALL WASHER AND BOLT (ITEMS 6 AND 7). TIGHTEN SECURELY.

2 — MATCH THREE-HOLE PATTERN OF HEAD UNIT ASSEMBLY (ITEM 18) WITH SWIVEL MOUNT (ITEM 17). USE SCREWS (ITEM 19) TO ATTACH HEAD UNIT. TIGHTEN SECURELY